

50-Ohm Load

698 – 2700 MHz

80 W

- Designed as 50-Ohm termination wherever improved intermodulation performance compared to standard loads is required
- **Excellent intermodulation performance**
- Suitable for indoor or outdoor applications
- Wall or mast mounting
- Built-in DC stop

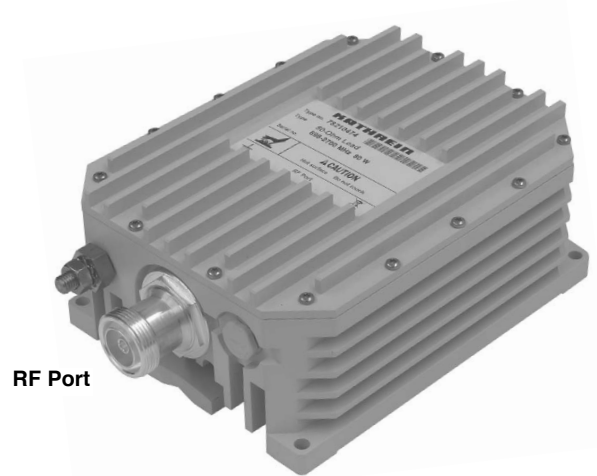

RF Port

Technical Data

Type No.	782 10474
Frequency range	698 – 2700 MHz
VSWR	< 1.12
Impedance	50 Ω
Input power	< 80 W (see table)
Intermodulation products	< -160 dBc (3 rd order; with 2 x 20 W)
Temperature range	-40 ... +55 °C
Connector	7-16 female (long neck)
Application	Indoor <i>or</i> outdoor (IP 66)
DC/AISG transparency	Built-in DC stop AISG: Attenuation up to 3 dB when used in a network
Mounting	Wall mounting: With 4 screws (max. 6.5 mm diameter) Mast mounting: With additional clamp set (see page 2)
Weight	3.1 kg
Packing size	377 x 232 x 189 mm
Dimensions (w x h x d)	143.6 x 216 x 79.2 mm (including connector)

Note:

The RF port connector should always point downwards if mounted outdoors.

The input power rating of 80 W is specified at an ambient temperature of +40 °C with the combiner mounted vertically, without additional cooling, and while respecting the safety standard EN IEC 60950 (max. surface temperature +90 °C).

The max. power rating increases or decreases with falling or rising ambient temperature and depending on horizontal or vertical mounting in accordance with the following table:

Max. input power

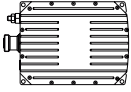
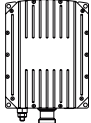
	Mounted horizontally	Mounted vertically
Max. ambient temperature		
+55 °C	50 W	60 W
+40 °C	70 W	80 W
+25 °C	90 W	100 W

936.3192/a Subject to alteration.

50-Ohm Load 698 – 2700 MHz 80 W

Accessories (order separately)

Type No.	Clamp set suitable for mast diameter of
734 360	34 – 60 mm
734 361	60 – 80 mm
734 362	80 – 100 mm
734 363	100 – 120 mm
734 364	120 – 140 mm
734 365	45 – 125 mm
*131 1847	50 – 145 mm

*U.S. Customers order 131 1847



Mast mounting with Kathrein Clamp set 734 360 ... 734 365

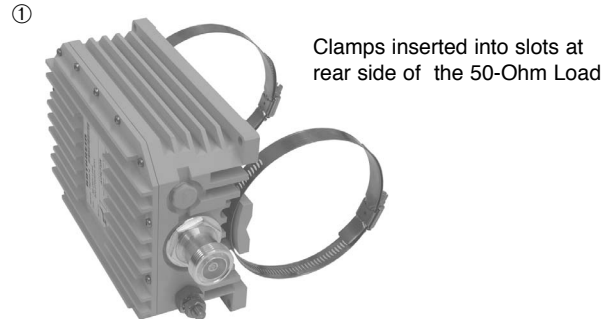

Clamps inserted into slots at rear side of the 50-Ohm Load

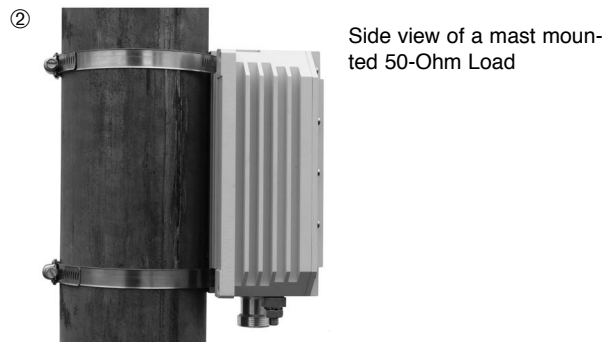

Side view of a mast mounted 50-Ohm Load

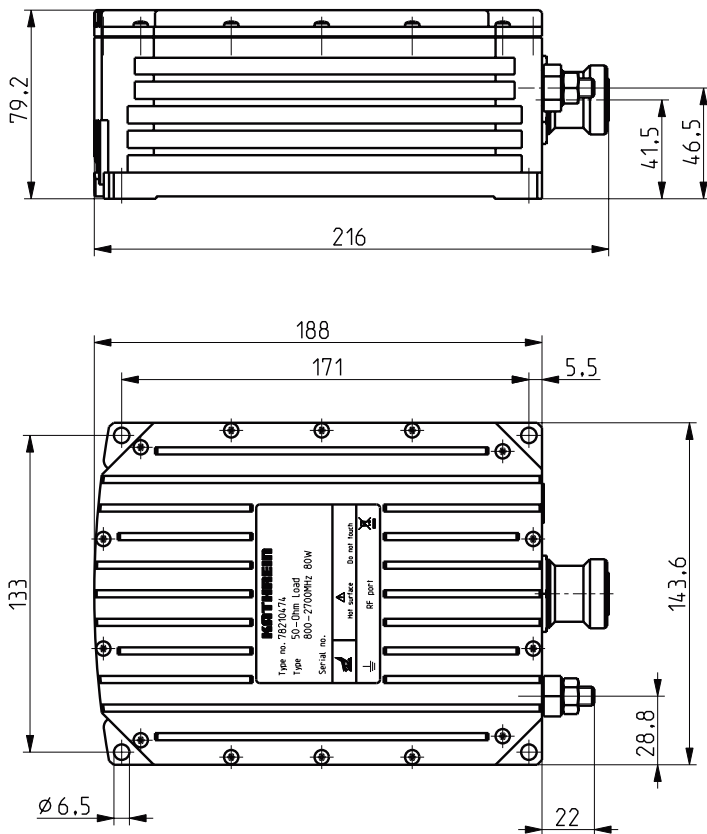

Please note:

As a result of more stringent legal regulations and judgements regarding product liability, we are obliged to point out certain risks that may arise when products are used under extraordinary operating conditions.

Extraordinary operating conditions, such as heavy icing or exceptional dynamic stress (e.g. strain caused by oscillating support structures), may result in the breakage of a mast mounted device or even cause it to fall to the ground.

These facts must be considered during the site planning process.

The 50-Ohm Load is designed to operate under the environmental conditions as described in ETS 300 019-1-4 class 4.1 E and have passed environmental tests as recommended in ETS 300 019-2-4.

The installation team must be properly qualified and also be familiar with the relevant national safety regulations.

The details given in our data sheets have to be followed carefully when installing the combiner and accessories.

The limits for the coupling torque of RF connectors, recommended by the connector manufacturers must be obeyed.

Any previous datasheet issues have now become invalid.

