

1-Port Indoor Antenna	790–960	1710–2700
Vertical Polarization	V	V
HPBW	90°	90°
Integrated Combiner	C	

1-Port Indoor 790–960/1710–2700 C 90° 7dBi

Type No.		80010465
Frequency range	MHz	790 – 960 / 1710 – 2700
Polarization		Vertical
Gain	dBi	Approx. 7
Half-power beam width	°	Horizontal: Approx. 90
Impedance	Ω	50
VSWR		790 – 806 MHz: < 2.2 806 – 960 MHz: < 2.0 1710 – 2700 MHz: < 2.0
Max. power	W	50 (at 50 °C ambient temperature)
Input		Cable RG 223/CU of 1m length, white, with N female connector
Protection class		IP 30
Weight	g lb	500 1.1
Packing size	mm inches	363 x 152 x 62 14.3 x 6.0 x 2.4
Height/width/depth	mm inches	231 / 140 / 50 9.1 / 5.5 / 2.0
Fire load		1.42 kWh

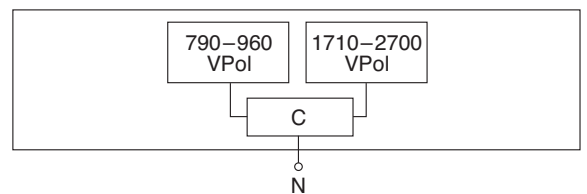

- Material:** Reflector: Aluminum. Radome: High impact polystyrol, colour: White. Additional painting is possible. Mounting plates: Stainless steel.
- Mounting:** Two holes of 6 mm | 0.24 inches diameter in the mounting plate. Screws are not supplied. Avoid stressing the cable. No stress on the hexagonal crimp. Minimum cable bending radius: 30 mm | 1.18 inches without tensile load. Cable must be fixed.
- Available accessories:** Broadband power splitters and tappers (790 – 2700 MHz).

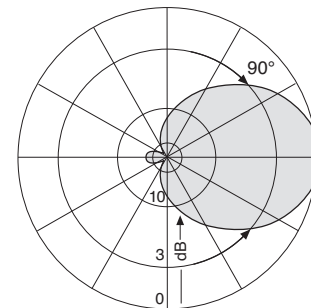

Horizontal Pattern

Mounting:

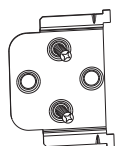

Mount the attachment plate to the wall using two screws of 4 mm | 0.16 inches diameter in the position as indicated.

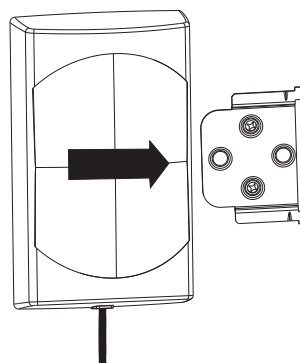

Align the antenna over the attachment plate.

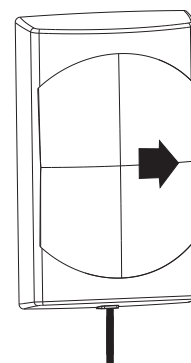

Pull the antenna to the stop.

936.3036/f Subject to alteration.

Any previous data sheet issues have now become invalid.

All specifications are subject to change without notice. The latest specifications are available at www.kathreinusa.com